

STC Model

“Stationary Power Operated 3 Jaw Chuck”

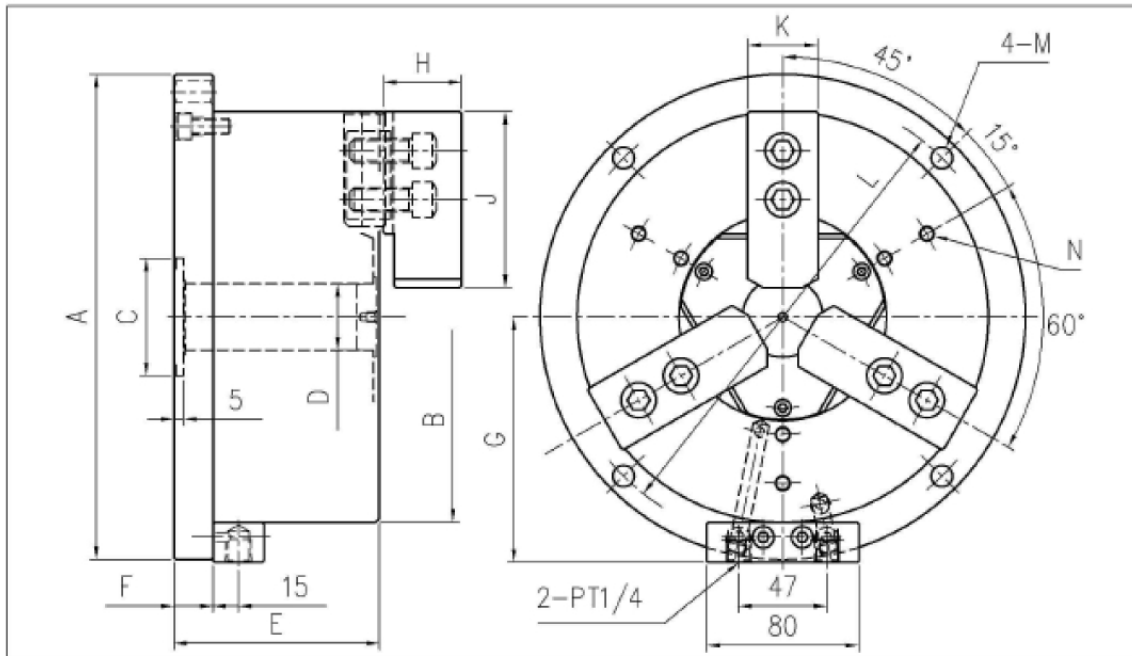

		Model			
Specification		STC-4	STC-6	STC-8	STC-10
Chuck Dia.		4"	6"	8"	10"
Jaw Stroke	mm	5.4	5.4	6.8	6.8
Shifter Stroke	mm	12	12	15	15
Gripping Force	kg	760	2100	3300	4700
Operating Air Pressure	kg/cm ²	6	6	6	6
Weight	kg	7	15.2	29	43.7
A		148	203	248	300
B		110	165	210	254
C		35	50	60	80
D		6	21	34	47
E		87	90	105	108
F		15	15	15	16
G		75.5	103	125.5	147.5
H		30	36	42	50
J		55	80	90	110
K		27	32	36	40
K2		78	78	78	78
L		130	185	230	280
M		9	11	11	13
N		3-M8	6-M8	6-M8	6-M8