

SOFT JAWS

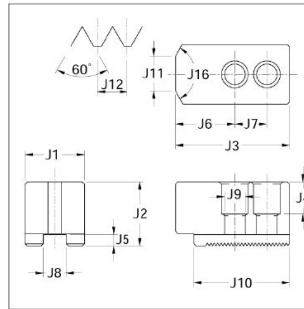

TYPE-S



TYPE-K

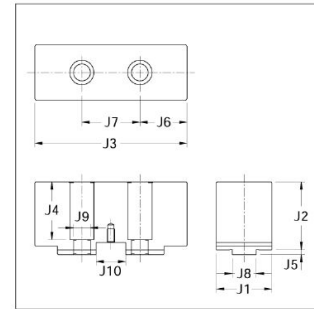

Jaw type	Chuck size	Reference No.	J1	J2	J3	J4	J5	J6	J7	J8	J9	J10	J11	J12	J16	Set bolt	Applicable model
S	4	61040008	26	28	50	14	5	26	14	10	9	42	6	1.5	120°	M8×28	H
	4,5	4605027	23	28	50	14	5	26	14	10	9	42	6	1.5	120°	M8×28	Z-4,Z-5
	5	61060104	23	25	65	15	5	38	19	10	9	65	5	1.5	120°	M8×22	HXA,HHXA
	6	60060001	30	34	80	26	3.5	41	25	11	9	70	6	1.5	90°	M8×22	HA
		60060101	30	34	80	26	3.5	41	25	11	9	70	6	1.5	90°	M8×22	HA ※
		62061640	27	30	70	20	5	33	25	11	9	51	5	1.5	120°	M8×25	ZA
	8	60080001	36	40	90	25	5	45	25	14	13	65	20	1.5	120°	M12×32	HA
		62080904	34	40	79	25	5	39	25	14	13	58	15	1.5	120°	M12×32	ZA
	10,11	60100001	40	48	110	31	6	50	30	16	13	90	25	1.5	120°	M12×32	HA
		60100101	40	48	103	31	6	50	32	16	13.5	88	25	1.5	120°	M12×32	HA ※
		60100301	40	42	110	27	5	50	30	16	13	75	16	1.5	120°	M12×32	ZA
		4610174	40	42	103	25	6	50	32	16	13.5	88	25	1.5	120°	M12×32	ZA ※
	12	60120001	50	50	130	33	6	60	30	18	15	100	30	1.5	120°	M14×40	HA
		60120101	50	50	140	33	6	68	32	18	15	102.5	20	1.5	90°	M14×40	HA ※
		4612165	46	50	112	33	6	52	30	18	15	90	25	1.5	120°	M14×40	ZA
		4612164	46	50	112	33	6	52	32	18	15	90	25	1.5	120°	M14×40	ZA ※
	15,18	60150101	62	62	150	43	8.5	55	50	22	22	122.5	62	3	—	M20×50	HA
		3615102	58	62	140	43	8.5	60	50	22	22	120	58	3	—	M20×50	ZA
K	21~24	3624011	73	95.3	200	75.8	6.3	61.9	76.2	31.75	22	38.88	—	—	—	M20	HHA
	28~40	3632006	80	95.3	200	75.8	6.3	61.9	76.2	31.75	22	38.88	—	—	—	M20	HHA

SPECIAL SOFT JAWS (When following soft jaws indicated as below sheet are used, rotation speed and gripping force are limited.)

Jaw type	Chuck size	Reference No.	J1	J2	J3	J4	J5	J6	J7	J8	J9	J10	J11	J12	J16	Specification	Applicable model
S	8	60080301	36	40	100	25	5	55	25	14	13	65	3	1.5	90°	for small dia	HA,ZA
		60080004	36	60	90	45	5	45	25	14	13	65	20	1.5	120°	J2:60	HA,ZA
		60080007	36	70	90	55	5	45	25	14	13	65	20	1.5	120°	J2:70	HA,ZA
		60080003	36	80	90	65	5	45	25	14	13	65	20	1.5	120°	J2:80	HA,ZA
	10,11	4610112	40	48	125	31	6	65	30	16	13	90	10	1.5	90°	for small dia	HA,ZA
		60100003	40	60	110	43	6	50	30	16	13	90	25	1.5	120°	J2:60	HA,ZA
		60100005	40	70	110	43	6	50	30	16	13	90	25	1.5	120°	J2:70	HA,ZA
		60100004	40	80	110	63	6	50	30	16	13	90	25	1.5	120°	J2:80	HA,ZA
		60100106	40	48	118	31	6	65	32	16	13.5	88	10	1.5	90°	for small dia	HA,ZA ※
		60100103	40	60	103	43	6	50	32	16	13.5	88	25	1.5	120°	J2:60	HA,ZA ※
12	60100104	40	80	103	63	6	50	32	16	13.5	88	25	1.5	120°	J2:80	HA,ZA ※	
	60120006	50	90	130	73	6	60	30	18	15	100	30	1.5	120°	J2:90	HA,ZA	

※ to application for HITACHI SEIKI MACHINES